

**CEBORA® P150® - CP 160®**

- P 90 - ART. 942
- P 92 - ART. 943
- P 120 - ART. 945
- P 122 - ART. 946
- P 150 - ART. 950
- P 152 - ART. 951
- P 162 - ART. 952

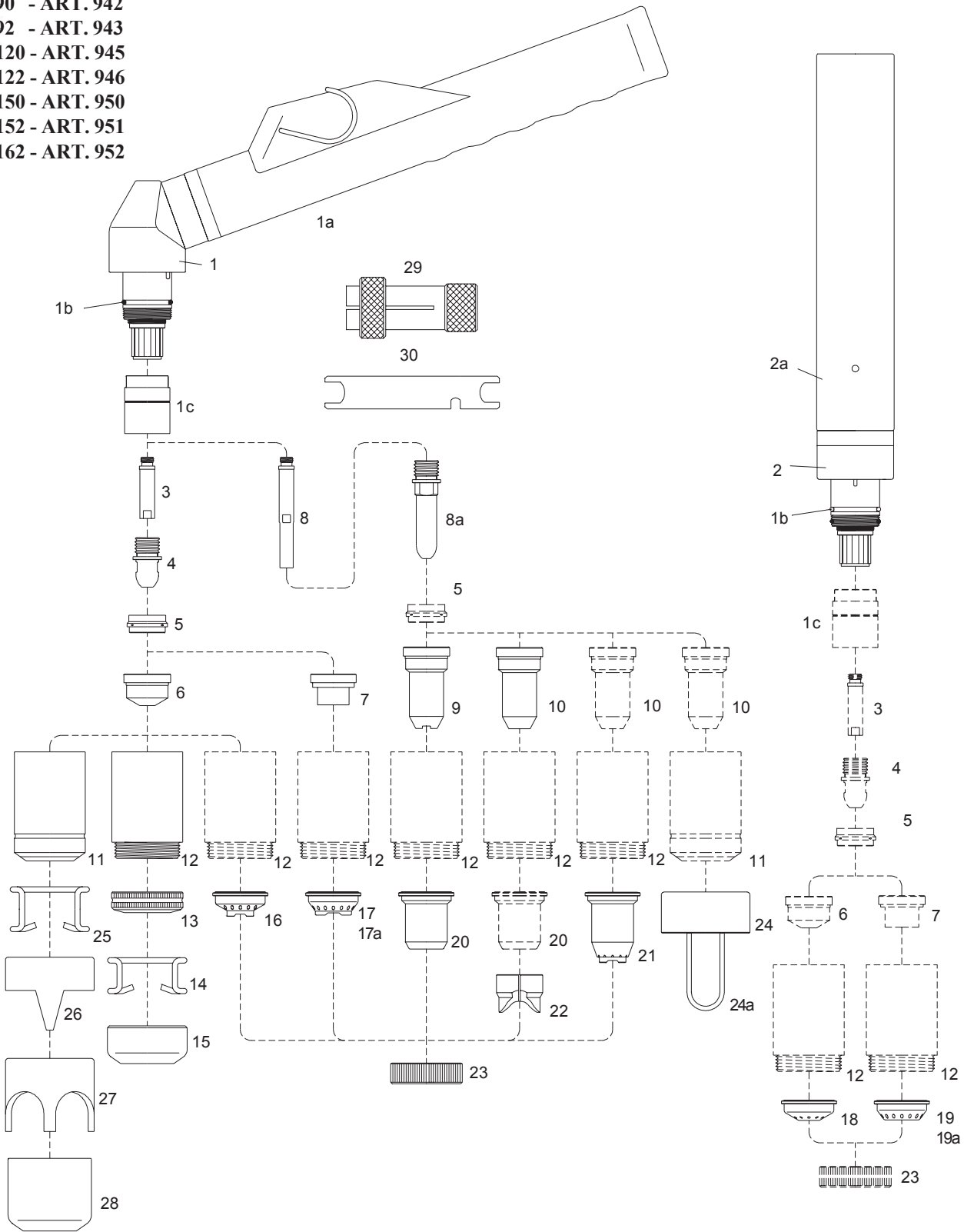

Complete Torches for **CP 160®**

Item	Ref.	Code	Description
	1226	04053/CS	Hand torch complete with 6 mts cable (central connector)
	1226.20	04153/CS	Hand torch complete with 12 mts cable (central connector)
	1228	08679	Machine torch complete with 6 mts shielded cable (central connector)
	1228.20	08685	Machine torch complete with 12 mts shielded cable (central connector)

**CEBORA® P150® - CP 160®**

Item	Ref.	Code	Description
	1571	04050/CS	Hand torch complete with 6 mts cable (1/8" connection)
	1576	04051/CS	Hand torch complete with 6 mts cable (central connector)
	1578	04151/CS	Hand torch complete with 12 mts cable (central connector)
	1529	04400/S	Machine torch complete with 6 mts cable (1/8" connection)
	1577	04401/S	Machine torch complete with 6 mts cable (central connector)
	1579	04501/S	Machine torch complete with 12 mts cable (central connector)
1	1353	02000	Hand torch head
1a		04280/C	Handgrip with microswitch
1b	1398	02000.60	O - Ring
1c		60080	Front insulator
2	1354	04300	Machine torch head
2a	3.055.623	03310	Machine handle
3	1378	05004	Diffusor
4	1376	52540	Electrode
5	1377	60020	Swirl ring
6	1371	51140/S	Tip long life ø 1,1
	1372	51141/S	Tip long life ø 1,35
	1373	51142/S	Tip long life ø 1,6
	1374	51143/S	Tip long life ø 1,8
	1375	51144	Gouging tip ø 3,0
7		51410	Contact tip ø 1,35
		51411	Contact tip ø 1,6
		51412	Contact tip ø 1,8
8		05005	Extended Diffusor
8a	1517	52549	Extended electrode
9	1369	51148	Contact extended tip max. 50A
10		51148.13	Extended tip ø 1,35 - 90A
		51148.16	Extended tip ø 1,6 - 120A
		51148.18	Extended tip ø 1,8 - 150A
11	1389	60330	Nozzle retaining cap
12		60350	Contact nozzle retaining cap,
		60350/V	Contact nozzle retaining cap, Max.life
13		51952	Spring holder protection nut
14		51911	Spacer spring for code 51952
15		51953	Gouging spacer
16		51950	Spacer for contact cutting, hand
17		51930	Spacer for contact cutting, hand
17a		51920	Spacer for contact cutting, hand
18		51951	Shield cup, machine
19		51935	Shield cup, machine
19a		51925	Shield cup, machine
20		51957	Shield cup, hand ( max. 50A )
21		51958	Spacer for contact cutting, hand
22		51974	Spacer for extended tips High Amp.
23		51959	Locking nut
24		60380	Spacer complete with springs
24a		60381	Spare springs
25	1386	51910	Spacer spring
26	1408	60370	Double pointed spacer
27		60371	Crown spacer
28	1406	60373	Gouging spacer
29	1509	60369	Extractor for swirl ring
30	3.045.010	60368	Wrench for electrode
		04240/S	Air and power cable 6 mts 1/8" - Hand torch
		04250/S	Air and power cable 12 mts 1/8" - Hand torch
		04320/S	Air and power cable 6 mts 1/8" - Machine torch
		04330/S	Air and power cable 12 mts 1/8" - Machine torch

\* SHIELDED TORCHES : See page # 66

\* CIRCLE CUTTING ATTACHMENT : See page # 70